

# SN STRUT NUT FOR DIN RAIL



## CERTIFICATIONS



## FEATURES

Designed to be installed on C-shaped DIN profiles

## SPECIFICATIONS

**Finish:** Electrogalvanized

**Material:** Steel

Table 1/1

Catalog Number	Article Number	Thread Size (TS)	Width (W)	Height (H)	Unit Weight
SNP-M4	560500	M4	37 mm	12 mm	0.02 kg
SNP-M5	560510	M5	37 mm	12 mm	0.02 kg
SNP-M6	560520	M6	37 mm	12 mm	0.02 kg
SNP-M8	560530	M8	37 mm	12 mm	0.02 kg

## DIAGRAMS

---

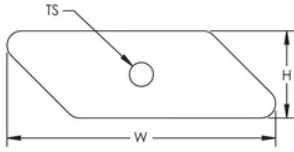

## WARNING

---

nVent products shall be installed and used only as indicated in nVent's product instruction sheets and training materials. Instruction sheets are available at [www.nvent.com](http://www.nvent.com) and from your nVent customer service representative. Improper installation, misuse, misapplication or other failure to completely follow nVent's instructions and warnings may cause product malfunction, property damage, serious bodily injury and death and/or void your warranty.

### North America

+1.800.753.9221  
Option 1 – Customer Care  
Option 2 – Technical Support

### Europe

Netherlands:  
+31 800-0200135  
France:  
+33 800 901 793

### Europe

Germany:  
800 1890272  
Other Countries:  
+31 13 5835404

### APAC

Shanghai:  
+ 86 21 2412 1618/19  
Sydney:  
+61 2 9751 8500



Our powerful portfolio of brands:  
**nVent.com CADDY ERICO HOFFMAN RAYCHEM SCHROFF**  
**TRACER**